

# Underground Drainage

EN1401 SN4



**DYKA**



Injection moulding department



DYKA plant

# At DYKA

We proudly state that we can provide you “just-in-time” with all possible solutions for your specific requirements related to plastic pipe systems. Our “no-nonsense” statement is based on the following impressive figures and facts: The DYKA premises near the town of Steenwijk in the Netherlands, solely occupies some 180.000 m<sup>2</sup>. A full-service plant with automated production lines, special engineering department, quality control, research & development, storage and logistics.

## Injection moulding

Our large number of special moulding machines do produce more than 44 million items per year, in any size and shape.

## Thermo forming

Flexibility and enormous innovative capacity offered by thermo forming have resulted in our company’s impressive range of plastic fittings. A product range that still offers ample potential for expansion, new applications are continually being discovered, and other plastics are being tested for their suitability for this renowned manufacturing technology.

## Extrusion

Excellent tuned extrusion lines do assure the non-stop production of pipes and conduits in every possible colour, diameter and specific technical specifications. Total output: more than 55.000 kilometres of plastic pipes per year!

## Storage & Logistics

Every day, full truck-loads and containers are shipped from our production plants in Europe, by road, air, train and waterway to satisfy the needs of our customers all over the world.

## Export Sales

Our eager export staff is only too willing to serve and assist you with technical advice, customs documents and after-sales service.

**Whatever you might need AT DYKA, we can do it for you!**



## Bend 15° - 1 x RS



Ø / D			A	B	M
110 mm	F	I	13	67	60
160 mm	F	I	17	92	68
200 mm	R	I	21	113	84
250 mm	R	T	30	135	110
315 mm	R	T	38	145	125
400 mm	R	T	48	155	155
500 mm	R	T	59	178	190

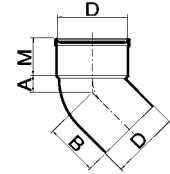

## Bend 22° 30' - 1 x RS



Ø / D			A	B	M
110 mm	F	I	16	73	64
125 mm	F	I	38	88	71
160 mm	F	I	22	109	89

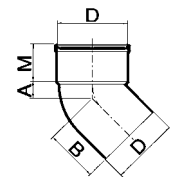

## Bend 30° - 1 x RS



Ø / D			A	B	M
110 mm	F	I	20	74	60
125 mm	F	I	25	84	63
160 mm	F	I	27	105	68
200 mm	R	I	34	127	84
250 mm	R	T	49	135	110
315 mm	R	T	61	145	135
400 mm	R	T	78	155	165
500 mm	R	T	97	178	190

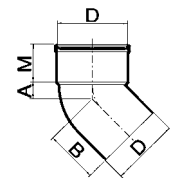

## Bend 45° - 1 x RS



Ø / D			A	B	M
110 mm	F	I	26	83	62
125 mm	F	I	34	93	64
160 mm	F	I	41	124	91
200 mm	F	I	52	141	81
250 mm	R	I	80	193	101
315 mm	R	T	86	145	125
400 mm	R	T	110	155	155
500 mm	R	T	137	178	190

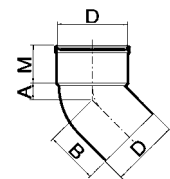

### Legend.

- F** = Fixed rubber ring
- R** = Removable rubber ring
- I** = Injection moulded
- T** = Thermo formed

**Bend 90° - 1 x RS**



Ø / D			A	B	M
110 mm	F	I	77	132	60
125 mm	F	I	106	170	72
160 mm	F	I	125	196	71
200 mm	F	I	155	244	81
250 mm	R	I	154	268	103
315 mm	R	T		630	135
400 mm	R	T		1070	165
500 mm	R	T	410	178	190
630 mm	R	T	970	935	205

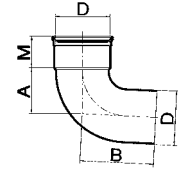

**Bend 15° - 2 x RS**



Ø / D			A	M
110 mm	F	I	13	60
125 mm	F	I	14	72
160 mm	F	I	17	68
200 mm	R	T	23	75
250 mm	R	T	30	110
315 mm	R	T	38	125
400 mm	R	T	48	155

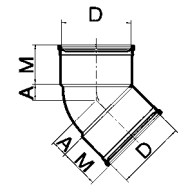

**Bend 22° 30' - 2 x RS**



Ø / D			A	M
110 mm	F	I	16	64
160 mm	F	I	22	89

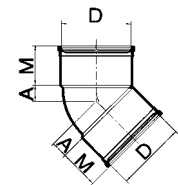

**Bend 30° - 2 x RS**



Ø / D			A	M
110 mm	F	I	20	60
125 mm	F	I	25	63
160 mm	F	I	27	68
200 mm	R	T	38	75
250 mm	R	T	49	110
315 mm	R	T	61	125
400 mm	R	T	78	155

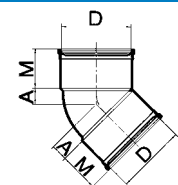

## Bend 45° - 2 x RS



Ø / D			A	M
110 mm	F	I	26	62
125 mm	F	I	32	65
160 mm	F	I	41	91
200 mm	F	I	52	80
250 mm	R	I	69	110
315 mm	R	T	86	125
400 mm	R	T	110	155

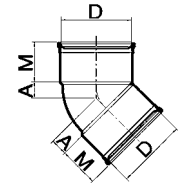

## Bend 90° - 2 x RS



Ø / D			A	M
110 mm	F	I	81	60
125 mm	F	I	105	62
160 mm	F	I	124	69
200 mm	F	I	155	81
250 mm	R	I	143	100
315 mm	R	T	630	135
500 mm	R	T	410	190
630 mm	R	T	970	205

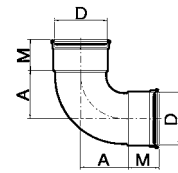

## Socket - 2 x RS



Ø / D			M	L
110 mm	F	I	64	3
125 mm	F	I	64	2
160 mm	F	I	69	3
200 mm	F	I	92	5
250 mm	R	T	110	30
315 mm	R	T	120	40
400 mm	R	T	145	50
500 mm	R	T	200	60
630 mm	R	T	225	70

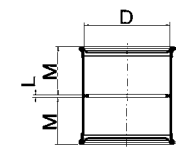

## Sleeve socket - 2 x RS



Ø / D			M
110 mm	F	I	66
125 mm	F	I	65
160 mm	F	I	71
200 mm	F	I	97
250 mm	R	T	110
315 mm	R	T	120
400 mm	R	T	145
500 mm	R	T	230
630 mm	R	T	225

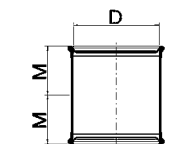

### Legend.

- F** = Fixed rubber ring
- R** = Removable rubber ring
- I** = Injection moulded
- T** = Thermo formed

## T-piece 90° - 2 x RS



Ø / D x d			c	M	m
110 x 110	F	I	63	64	64
125 x 110	F	I	68	72	64
125 x 125	F	I	69	66	66
160 x 110	F	I	82	60	60
160 x 160	F	I	83	69	69
200 x 110	R	T	120	100	110
200 x 125	R	T	120	100	125
200 x 160	R	T	120	100	160
200 x 200	R	T	125	100	200
250 x 110	R	T	145	110	110
250 x 125	R	T	145	110	125
250 x 160	R	T	150	110	160
250 x 200	R	T	155	110	200
250 x 250	R	T	155	110	250
315 x 110	R	T	185	120	110
315 x 125	R	T	185	120	125
315 x 160	R	T	180	120	160
315 x 200	R	T	185	120	200
315 x 250	R	T	190	120	250
315 x 315	R	T	195	120	315
400 x 110	R	T	220	145	110
400 x 160	R	T	220	145	160
400 x 200	R	T	225	145	200
400 x 250	R	T	225	145	250
400 x 315	R	T	240	165	315
400 x 400	R	T	240	165	400
500 x 160	R	T	310	200	160
500 x 200	R	T	315	200	200
500 x 250	R	T	315	200	250
500 x 315	R	T	320	200	315
500 x 400	R	T	325	200	400
500 x 500	R	T	400	200	500
630 x 110	R	T	425	225	110
630 x 125	R	T	425	225	125
630 x 160	R	T	425	225	160
630 x 200	R	T	430	225	200
630 x 250	R	T	435	225	250
630 x 315	R	T	435	225	315
630 x 400	R	T	440	225	400
630 x 500	R	T	460	225	500
630 x 630	R	T	415	225	630

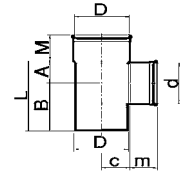

## T-piece 45° - 2 x RS



Ø / D x d			A	B	c	M	m
110 x 110	F	I	136	83	136	60	60
125 x 110	F	I	146	83	149	63	60
125 x 125	F	I	155	93	155	63	63
160 x 110	F	I	161	79	171	69	60
160 x 160	F	I	196	115	196	69	69
200 x 110	F	T	250	140	235	100	70
200 x 160	F	I	221	113	222	92	92
200 x 200	F	I	244	141	244	92	92
250 x 110	F	T	280	120	270	110	70
250 x 125	F	T	280	120	280	110	75
250 x 160	F	T	310	150	295	110	85
250 x 200	F	T	330	180	325	110	100
250 x 250	R	T	380	210	350	110	110
315 x 110	R	T	315	100	320	120	70
315 x 125	R	T	315	100	325	120	75
315 x 160	R	T	340	125	340	120	85
315 x 200	R	T	375	155	370	120	100
315 x 250	R	T	415	190	400	120	110
315 x 315	R	T	465	240	430	120	120
400 x 110	R	T	395	100	380	145	70
400 x 125	R	T	395	100	385	145	75
400 x 160	R	T	395	100	400	145	85
400 x 200	R	T	445	155	430	145	100
400 x 250	R	T	445	155	450	145	110
400 x 315	R	T	520	335	460	145	120
400 x 400	R	T	580	375	640	145	145
500 x 160	R	T	475	165	500	200	85
500 x 200	R	T	550	250	565	200	100
500 x 250	R	T	550	250	600	200	110
500 x 315	R	T	600	300	635	200	120
500 x 400	R	T	650	350	700	200	145
500 x 500	R	T	750	450	735	200	200
630 x 110	R	T	500	100	630	225	70
630 x 160	R	T	585	180	655	225	85
630 x 200	R	T	585	180	675	225	100
630 x 250	R	T	585	180	700	225	110
630 x 315	R	T	685	280	735	225	120
630 x 400	R	T	760	355	800	225	145
630 x 500	R	T	835	430	835	225	200

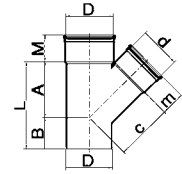

### Legend.

- F** = Fixed rubber ring
- R** = Removable rubber ring
- I** = Injection moulded
- T** = Thermo formed



## T-piece 90° - 3 x RS



Ø / D x d			A	B	c	M	m
110 x 110	F	I	60	60	60	60	60
125 x 110	F	I	61	61	68	72	64
125 x 125	F	I	70	70	70	64	64
160 x 110	F	I	58	58	81	69	60
160 x 125	F	I	70	70	82	89	72
160 x 160	F	I	83	83	83	69	69
200 x 110	R	T	100	100	120	100	70
200 x 125	F	I	66	66	102	93	72
200 x 160	F	I	84	84	104	93	89
200 x 200	F	I	103	103	103	93	93
250 x 110	R	T	103	103	145	110	70
250 x 125	R	T	103	103	145	110	75
250 x 160	R	T	123	123	150	110	85
250 x 200	R	T	145	145	155	110	100
250 x 250	R	T	173	173	155	110	110
315 x 110	R	T	110	110	185	120	70
315 x 125	R	T	110	110	185	120	75
315 x 160	R	T	128	128	180	120	85
315 x 200	R	T	150	150	185	120	100
315 x 250	R	T	183	183	190	120	110
315 x 315	R	T	213	213	195	120	120
400 x 110	R	T	148	148	220	145	70
400 x 125	R	T	148	148	220	145	75
400 x 160	R	T	148	148	220	145	85
400 x 200	R	T	180	180	225	145	100
400 x 250	R	T	180	180	225	145	110
400 x 315	R	T	275	275	240	165	120
400 x 400	R	T	275	275	240	165	145
500 x 110	R	T	160	160	310	200	70
500 x 125	R	T	160	160	310	200	75
500 x 160	R	T	160	160	310	200	85
500 x 200	R	T	220	220	315	200	100
500 x 250	R	T	220	220	315	200	110
500 x 315	R	T	300	300	320	200	120
500 x 400	R	T	300	300	325	200	145
500 x 500	R	T	350	350	400	200	200
630 x 630	R	T	470	470	415	225	225

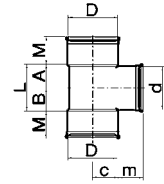

## T-piece 45° - 3 x RS



Ø / D x d			A	B	c	M	m
110 x 110	F	I	133	28	138	64	64
125 x 110	F	I	146	26	149	64	61
125 x 125	F	I	153	35	156	62	62
160 x 110	F	I	156	6	167	69	60
160 x 125	F	I	174	18	179	88	72
160 x 160	F	I	196	42	196	69	69
200 x 110	R	T	250	40	235	100	70
200 x 125	F	I	196	-3	203	92	73
200 x 160	F	I	224	14	222	92	89
200 x 200	F	I	244	47	244	92	92
250 x 110	R	T	280	10	270	110	70
250 x 125	R	T	280	10	280	110	75
250 x 160	R	T	310	40	295	110	85
250 x 200	R	T	330	70	325	110	100
250 x 250	R	T	380	100	350	110	110
315 x 110	R	T	315	-15	320	120	70
315 x 125	R	T	315	-15	325	120	75
315 x 160	R	T	340	10	340	120	85
315 x 200	R	T	375	40	370	120	100
315 x 250	R	T	415	75	400	120	110
315 x 315	R	T	465	125	430	120	120
400 x 110	R	T	395	-25	380	145	70
400 x 125	R	T	395	-25	385	145	75
400 x 160	R	T	395	-25	400	145	85
400 x 200	R	T	445	30	430	145	100
400 x 250	R	T	445	30	450	145	110
400 x 315	R	T	520	190	460	145	120
400 x 400	R	T	580	230	640	145	145
500 x 110	R	T	415	-95	500	200	70
500 x 125	R	T	475	-35	500	200	75
500 x 160	R	T	475	-35	500	200	85
500 x 200	R	T	550	50	565	200	100
500 x 250	R	T	550	50	600	200	110
500 x 315	R	T	600	100	635	200	120
500 x 400	R	T	650	150	700	200	145
500 x 500	R	T	750	250	735	200	200

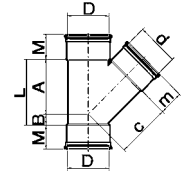

### Legend.

- F** = Fixed rubber ring
- R** = Removable rubber ring
- I** = Injection moulded
- T** = Thermo formed

## Double T-piece 90° - 3 x RS



Ø / D x d			L	A	a	Z
160 x 110	R	T	400	85	70	100
160 x 160	R	T	400	85	85	100
200 x 110	R	T	400	100	70	120
200 x 200	R	T	480	100	100	125
250 x 110	R	T	425	110	70	145
250 x 160	R	T	465	110	85	150
250 x 200	R	T	510	110	100	150
250 x 250	R	T	565	110	110	155
315 x 315	R	T	660	120	120	195
400 x 200	R	T	630	145	100	225
500 x 200	R	T	800	200	100	315
500 x 500	R	T	1000	200	200	400

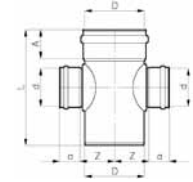

## Double T-piece 45° - 3 x RS



Ø / D x d			L	A	a	Z1	Z2
160 x 110	R	T	425	85	70	220	210
160 x 160	R	T	490	85	85	250	230
200 x 110	R	T	490	100	70	250	235
200 x 160	R	T	515	100	85	265	260
200 x 200	R	T	590	100	100	300	285
250 x 110	R	T	510	110	70	280	270
250 x 160	R	T	570	110	85	310	295
250 x 200	R	T	620	110	100	330	325
250 x 250	R	T	700	110	110	380	350
315 x 250	R	T	725	120	110	415	400
315 x 315	R	T	825	120	120	465	430

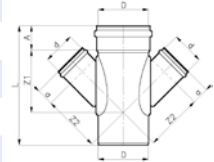

## Double T-piece 90° - 4 x RS



Ø / D x d			L	A	a	Z
200 x 200	R	T	480	100	100	125
315 x 200	R	T	540	120	100	185
500 x 500	R	T	1100	200	200	400

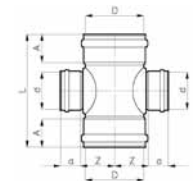

## Double T-piece 45° - 4 x RS



Ø / D x d			L	A	a	Z1	Z2
200 x 200	R	T	590	100	100	300	330
250 x 200	R	T	620	110	100	330	325
315 x 200	R	T	655	120	100	375	370

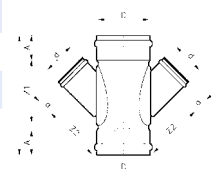

## Rodding piece - 2 x RS



Ø / D			A	L	C	M	x
110 mm	F	I	63	126	85	64	125
125 mm	F	I	80	160	102	72	160
160 mm	F	I	77	154	120	89	160

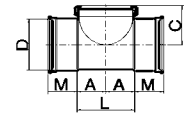

## Rodding piece - 2 x RS



Ø / D			L	C	M	A x B
125 mm	F	I	258	90	72	250 x 125
160 mm	F	I	286	120	86	255 x 152

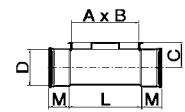

## Reducer - 1 x RS



Ø / D x d			A	B	L	E	M
125 x 110	F	I	14	69	83	7	64
160 x 110	F	I	33	85	118	25	64
160 x 125	F	I	25	86	111	17	72
200 x 125	F	I	50	90	140	38	72
200 x 160	F	I	28	91	119	19	89
250 x 200	R	T	70	145	215		100
315 x 200	R	T	135	155	290		100
315 x 250	R	T	85	150	235		120
400 x 315	R	T	110	180	290		120
500 x 400	R	T	142	188	330		165

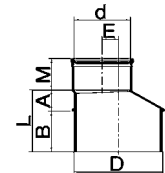

## Semi ecc. reducer - 1 x RS



Ø / D x d			L	A	B	Z
315 x 110	R	T	300	70	145	85
315 x 160	R	T	315	85	145	85
400 x 200	R	T	370	100	165	105
400 x 250	R	T	380	110	165	105

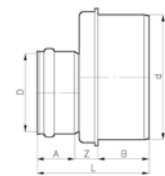

## Centric reducer - 1 x RS



Ø / D x d			L	A	B	Z
400 x 200	R	T	370	100	165	105
400 x 315	R	T	395	120	165	110
500 x 315	R	T	280	120	180	-20

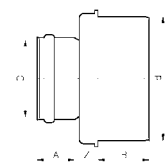

### Legend.

- F** = Fixed rubber ring
- R** = Removable rubber ring
- I** = Injection moulded
- T** = Thermo formed

## End cap



Ø / D		L
110 mm	I	36
125 mm	I	37
160 mm	I	37
200 mm	I	46
250 mm	T	37
315 mm	T	47
400 mm	T	80
500 mm	T	55
630 mm	T	95

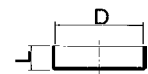

## Cap in socket and on spigot



Ø / D		d	s	t
125 mm	I	125	29	25
160 mm	I	160	30	25
315 mm	I	315	47	36

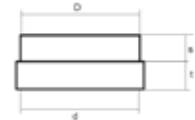

## End piece with screw cover



Ø / D		A	B	L	D1
110 mm	I	21	65	86	124
125 mm	I	23	71	94	141
160 mm	I	28	96	124	177

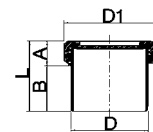

## End cap in socket



Ø / D		L
110 mm	I	
125 mm	I	50
160 mm	I	54
200 mm	I	64
250 mm	T	163
315 mm	T	166
400 mm	T	206



## Transition piece PVC - C.I. pipe

	Ø / D			Rubber ring
	110 x 157	R	T	124,5 x 12
	125 x 157	R	T	124,5 x 12
	160 x 184	R	T	148 x 12
	200 x 232	R	T	174 x 12

The connection to the c.i. pipe is made by thermal shrink with flame torch.

## Transition piece PVC - Clay pipe

	Ø / D			Rubber ring
	110 x 180	R	T	148 x 12
	125 x 180	R	T	148 x 12
	125 x 206	R	T	174 x 12
	160 x 206	R	T	174 x 12

The connection to the clay pipe is made by thermal shrink with flame torch.

## Drip flange - 1 x RS

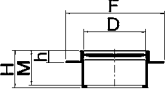
	Ø / D x d		H	M	h	F	
	110 mm	T	80	65	10	200	
	125 mm	I	75	69	25	199	
	160 mm	T	78	65	34	240	
	200 mm	T	112	95	19	330	
	250 mm	T	130	110	18	330	
	315 mm	T	150	125	18	400	
	400 mm	T	180	155	21	500	
	500 mm	T	225	190	30	660	

### Legend.

- F** = Fixed rubber ring
- R** = Removable rubber ring
- I** = Injection moulded
- T** = Thermo formed



# PP Inspection chamber

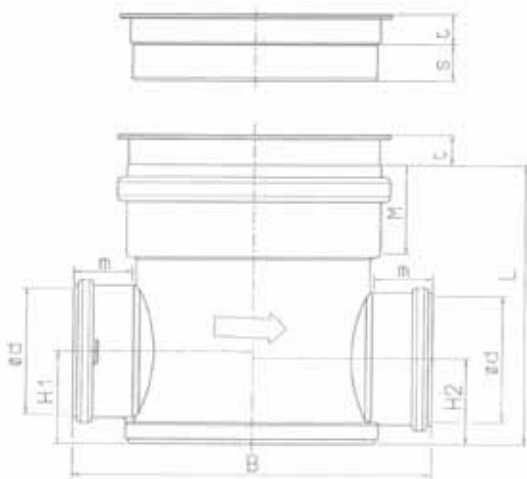

PP Inspection chamber											
Ø / D			s	t	d	m	M	H1	H2	L	B
250 x 125		I			125	70	101	101	94	305	379
250 x 160		I			160	76	101	119	112	305	400
315 x 125	Including cover	I	47	38	125	70	112	107	98	362	439
315 x 160	Including cover	I	47	38	160	76	112	124	115	362	459
315 x 200	Including cover	I	47	38	200	86	112	144	135	362	481
400 x 125		I			125	69	129	96	85	368	522
400 x 160		I			160	77	129	114	102	368	541
400 x 200		I			200	86	129	135	123	368	558



Riser



$\emptyset / D$	D	d	L
467 x 235	467	467	235



Chamber base

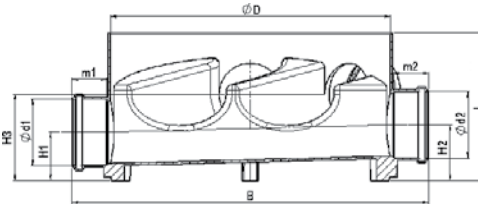
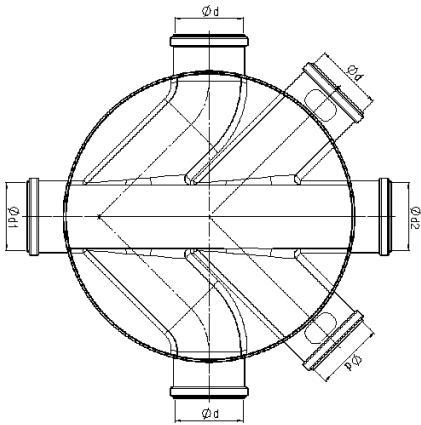

$\emptyset$	D	d1	d2	d	m1	m2	H1	H2	H3	L	B
467 x 110	467	110	110	110	58	58	81	93	144	247	595



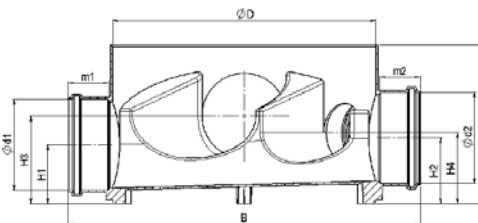
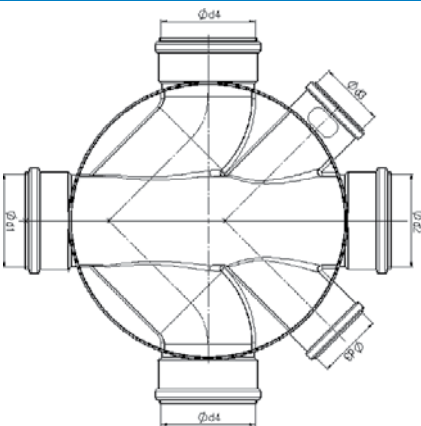



Chamber base



$\emptyset$	D	d1	d2	d3	d4	m1	m2	H1	H2	H3	H4	L	B
467 x 160 x 110	467	160	160	110	160	72	72	104	116	155	125	280	626

# Axedo

Base components

	Diameter (mm)				
	160	200	250	315	400
	✓	✓	✓	✓	✓
	✓	✓	✓	✓	
	✓	✓	✓	✓	
	✓	✓	✓	✓	
	✓	✓	✓	✓	
	✓	✓	✓	✓	
	✓	✓	✓	✓	

	H (mm)	A (mm)	B (mm)	C (mm)
160	383,7	158,4	193,3	32,0
200	425,7	158,4	235,3	32,0
250	478,3	158,4	287,9	32,0
315	546,7	158,4	356,3	32,0
400	636,3	158,4	445,9	32,0





Riser pipe		
De (mm)	Di (mm)	Height (mm)
678	600	1000
678	600	1500
678	600	2000
678	600	3000
678	600	6000



Seal



Concrete slab

Accessoires	
	Article number
Rubber seal riser pipe	20042547
Rubber seal concrete slab	20034173
Concrete slab	20034168
Manhole cover D400	20034170

### Technical specifications concrete slab

- Weight : 210 kg.
- Designed to provide resistance to heavy traffic
- Concrete with a compression resistance > 450 kN.
- Equipped with 4 anchors



# PVC Mechanical saddle

While preparing the main sewer for house- or street gully-connections, it is not always known where to position the branch connection. For such an installation often a T-piece is used. This requires already at the time of a new installation that its exact location should be determined.

The DYKA mechanical saddle offers the possibility, both in new and existing sewer lines, to make a flexible and easy to install connection. The mechanical saddle is watertight and is economically justified.

PVC Mechanical saddle					
	Ø		D	H	M
	200 x 125	F	125	231	64
	250 x 125	F	125	256	64
	315 x 125	F	125	289	64
	400 x 125	F	125	331	64
	250 x 160	F	160	260	67
	315 x 160	F	160	293	67
	400 x 160	F	160	335	67
	500 x 160	F	160	385	67
	630 x 160	F	160	450	67



The DYKA mechanical saddle is suitable for smooth PVC pipes SN4 and SN8, both for multi-layer as well as solid PVC pipes.

Roundshaw for mechanical saddle	
	Ø
	125 mm
	160 mm

1. Drill a hole on the crown of the pipe by using the roundsaw.

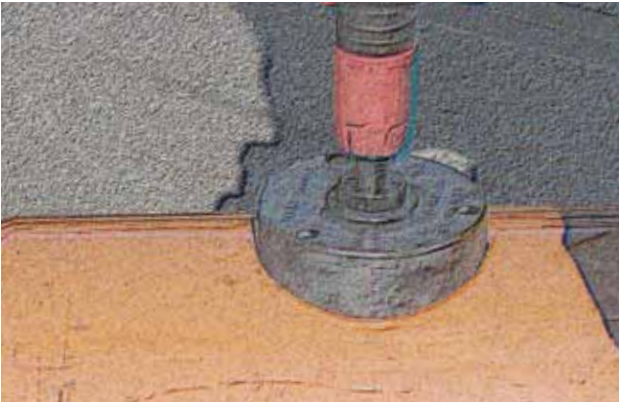

2. Remove any debris by file or wire brush.



3. Insert the DYKA mechanical saddle in the hole.

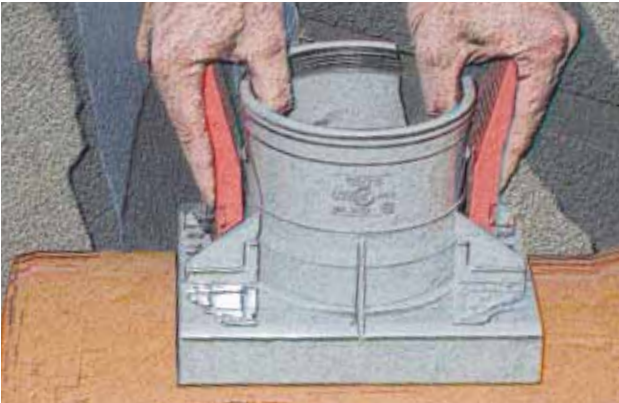

4. Push the red levers simultaneously till it's locked.

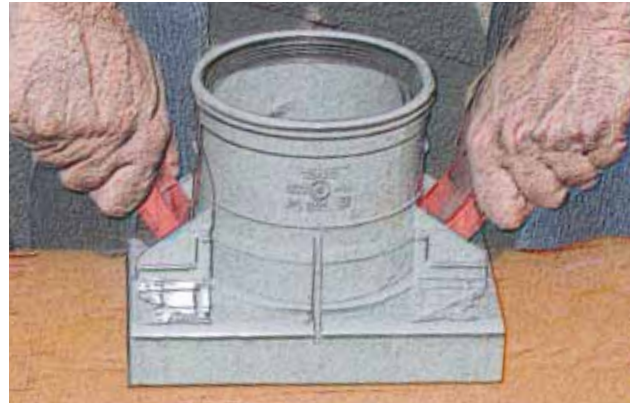

5. DYKA mechanical saddle is installed.

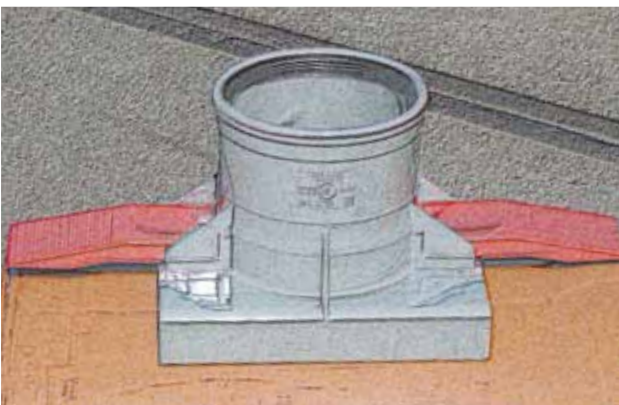

6. Perfectly straight, watertight and ready to complete the connection.



# PP Inspection chamber

PP Inspection chamber type G for corrugated pipes DN / OD 355 (with foot)

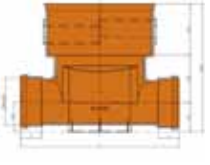
	DN/OD	h1	h2	h3	h4	h5	t	L	
	mm	mm	mm	mm	mm	mm	mm	mm	
	<b>160</b>	100	103,5	163,5	175	438,5	74	550	
<b>200</b>	120	123,5	163,5	175	458,5	84,5	570		

PP Inspection chamber type G DN / OD 315 (with foot)

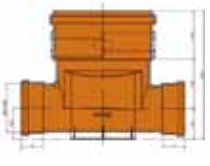
	DN/OD	h1	h2	h3	h4	h5	t	L	
	mm	mm	mm	mm	mm	mm	mm	mm	
	<b>160</b>	100	103,5	163,5	160	423,5	74	550	
<b>200</b>	120	123,5	163,5	160	443,5	84,5	570		

PP Inspection chamber type G DN / OD 400 (with foot)

	DN/OD	h1	h2	h3	h4	h5	t	L	
	mm	mm	mm	mm	mm	mm	mm	mm	
	<b>160</b>	100	103,5	178	203	481,5	74	630	
<b>200</b>	120	123,5	178	203	501,5	84,5	650		
<b>250</b>	145	148,5	178	203	526,5	112	700		

## Legend.

- F** = Fixed rubber ring
- R** = Removable rubber ring
- I** = Injection moulded
- T** = Thermo formed

## Bend 15° - 1 x RS



Ø / D			A	B	M
110 mm	F	I	13	67	60
160 mm	F	I	17	92	68
200 mm	F	I	21	113	84
250 mm	R	T	30	135	110
315 mm	R	T	38	145	125
400 mm	R	T	48	155	155
500 mm	R	T	59	178	190

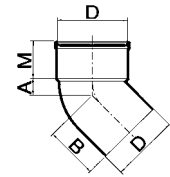

## Bend 22° 30' - 1 x RS



Ø / D			A	B	M
110 mm	F	I	16	73	64
125 mm	F	I	38	88	71
160 mm	F	I	22	109	89

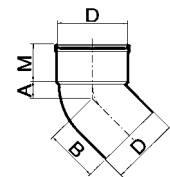

## Bend 30° - 1 x RS



Ø / D			A	B	M
110 mm	F	I	20	74	60
125 mm	F	I	25	84	63
160 mm	F	I	27	105	68
200 mm	R	I	34	127	84
250 mm	R	T	49	135	110
315 mm	R	T	61	145	135
400 mm	R	T	78	155	165
500 mm	R	T	97	178	190

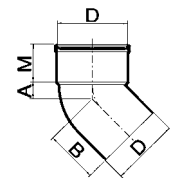

## Bend 45° - 1 x RS



Ø / D			A	B	M
110 mm	F	I	26	83	62
125 mm	F	I	34	93	64
160 mm	F	I	41	124	91
200 mm	F	I	52	141	81
250 mm	R	I	80	193	101
315 mm	R	T	86	145	125
400 mm	R	T	110	155	155
500 mm	R	T	137	178	190

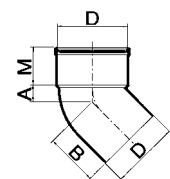

## Bend 90° - 1 x RS



Ø / D			A	B	M
110 mm	F	I	77	132	60
125 mm	F	I	106	170	72
160 mm	F	I	125	196	71
200 mm	F	I	155	244	81
250 mm	R	I	154	268	103
315 mm	R	T		630	135
400 mm	R	T		1070	165
500 mm	R	T	410	178	190
630 mm	R	T	970	935	205

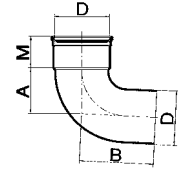

## Bend 15° - 2 x RS



Ø / D			A	M
110 mm	F	I	13	60
125 mm	F	I	14	72
160 mm	F	I	17	68
200 mm	R	T	23	75
250 mm	R	T	30	110
315 mm	R	T	38	125
400 mm	R	T	48	155

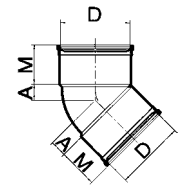

## Bend 22° 30' - 2 x RS



Ø / D			A	M
110 mm	F	I	16	64
160 mm	F	I	22	89

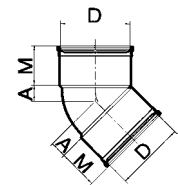

## Bend 30° - 2 x RS



Ø / D			A	M
110 mm	F	I	20	60
125 mm	F	I	25	63
160 mm	F	I	27	68
200 mm	R	T	38	75
250 mm	R	T	49	110
315 mm	R	T	61	125
400 mm	R	T	78	155

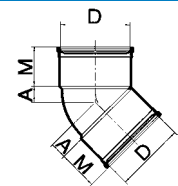

### Legend.

- F** = Fixed rubber ring
- R** = Removable rubber ring
- I** = Injection moulded
- T** = Thermo formed



## Bend 45° - 2 x RS



Ø / D			A	M
110 mm	F	I	26	62
125 mm	F	I	32	65
160 mm	F	I	41	91
200 mm	F	I	52	80
250 mm	R	I	69	110
315 mm	R	T	86	125
400 mm	R	T	110	155

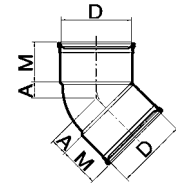

## Bend 90° - 2 x RS



Ø / D			A	M
110 mm	F	I	81	60
125 mm	F	I	105	62
160 mm	F	I	124	69
200 mm	F	I	155	81
250 mm	R	I	143	100
315 mm	R	T	630	135
500 mm	R	T	410	190
630 mm	R	T	970	205

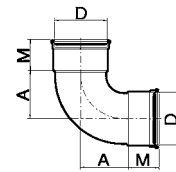

## Socket - 2 x RS



Ø / D			M	L
110 mm	F	I	64	3
125 mm	F	I	64	2
160 mm	F	I	69	3
200 mm	F	I	92	5
250 mm	R	T	110	30
315 mm	R	T	120	40
400 mm	R	T	145	50
500 mm	R	T	200	60
630 mm	R	T	225	70

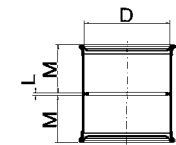

## Sleeve socket - 2 x RS



Ø / D			M
110 mm	F	I	66
125 mm	F	I	65
160 mm	F	I	71
200 mm	F	I	97
250 mm	R	T	112
315 mm	R	T	117
400 mm	R	T	145
500 mm	R	T	230
630 mm	R	T	225

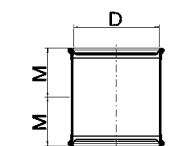

## T-piece 90° - 2 x RS



Ø / D x d			c	M	m
110 x 110	F	I	63	64	64
125 x 110	F	I	68	72	64
125 x 125	F	I	69	66	66
160 x 110	F	I	83	69	69
160 x 160	F	I	82	60	60
200 x 110	R	T	120	100	110
200 x 125	R	T	120	100	125
200 x 160	R	T	120	100	160
200 x 200	R	T	125	100	200
250 x 110	R	T	145	110	110
250 x 125	R	T	145	110	125
250 x 160	R	T	150	110	160
250 x 200	R	T	155	110	200
250 x 250	R	T	155	110	250
315 x 110	R	T	185	120	110
315 x 125	R	T	185	120	125
315 x 160	R	T	180	120	160
315 x 200	R	T	185	120	200
315 x 250	R	T	190	120	250
315 x 315	R	T	195	120	315
400 x 110	R	T	220	145	110
400 x 160	R	T	220	145	160
400 x 200	R	T	225	145	200
400 x 250	R	T	225	145	250
400 x 315	R	T	240	165	315
400 x 400	R	T	240	165	400
500 x 160	R	T	310	200	160
500 x 200	R	T	315	200	200
500 x 250	R	T	315	200	250
500 x 315	R	T	320	200	315
500 x 400	R	T	325	200	400
500 x 500	R	T	400	200	500
630 x 110	R	T	425	225	110
630 x 125	R	T	425	225	125
630 x 160	R	T	425	225	160
630 x 200	R	T	430	225	200
630 x 250	R	T	435	225	250
630 x 315	R	T	435	225	315
630 x 400	R	T	440	225	400
630 x 500	R	T	460	225	500
630 x 630	R	T	415	225	630

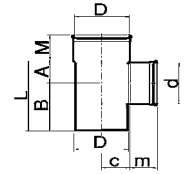

### Legend.

- F** = Fixed rubber ring
- R** = Removable rubber ring
- I** = Injection moulded
- T** = Thermo formed

## T-piece 45° - 2 x RS



Ø / D x d			A	B	c	M	m
110 x 110	F	I	136	83	136	60	60
125 x 110	F	I	146	83	149	63	60
125 x 125	F	I	155	93	155	63	63
160 x 110	F	I	196	115	196	69	69
160 x 160	F	I	161	79	171	69	60
200 x 110	R	T	250	140	235	100	70
200 x 160	F	I	244	141	244	92	92
200 x 200	F	I	221	113	222	92	92
250 x 110	F	T	280	120	270	110	70
250 x 125	F	T	280	120	280	110	75
250 x 160	F	T	310	150	295	110	85
250 x 200	F	T	330	180	325	110	100
250 x 250	R	T	380	210	350	110	110
315 x 110	R	T	315	100	320	120	70
315 x 125	R	T	315	100	325	120	75
315 x 160	R	T	340	125	340	120	85
315 x 200	R	T	375	155	370	120	100
315 x 250	R	T	415	190	400	120	110
315 x 315	R	T	465	240	430	120	120
400 x 110	R	T	395	100	380	145	70
400 x 125	R	T	395	100	385	145	75
400 x 160	R	T	395	100	400	145	85
400 x 200	R	T	445	155	430	145	100
400 x 250	R	T	445	155	450	145	110
400 x 315	R	T	520	335	460	145	120
400 x 400	R	T	580	375	640	145	145
500 x 160	R	T	475	165	500	200	85
500 x 200	R	T	550	250	565	200	100
500 x 250	R	T	550	250	600	200	110
500 x 315	R	T	600	300	635	200	120
500 x 400	R	T	650	350	700	200	145
500 x 500	R	T	750	450	735	200	200
630 x 110	R	T	500	100	630	225	70
630 x 160	R	T	585	180	655	225	85
630 x 200	R	T	585	180	675	225	100
630 x 250	R	T	585	180	700	225	110
630 x 315	R	T	685	280	735	225	120
630 x 400	R	T	760	355	800	225	145
630 x 500	R	T	835	430	835	225	200

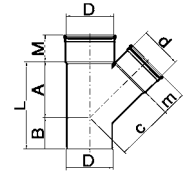

## T-piece 90° - 3 x RS



Ø / D x d			A	B	c	M	m
110 x 110	F	I	60	60	60	60	60
125 x 110	F	I	61	61	68	72	64
125 x 125	F	I	70	70	70	64	64
160 x 110	F	I	58	58	81	69	60
160 x 125	F	I	70	70	82	89	72
160 x 160	F	I	83	83	83	69	69
200 x 110	R	T	100	100	120	100	70
200 x 125	F	I	66	66	102	93	72
200 x 160	F	I	84	84	104	93	89
200 x 200	F	I	103	103	103	93	93
250 x 110	R	T	103	103	145	110	70
250 x 125	R	T	103	103	145	110	75
250 x 160	R	T	123	123	150	110	85
250 x 200	R	T	145	145	155	110	100
250 x 250	R	T	173	173	155	110	110
315 x 110	R	T	110	110	185	120	70
315 x 125	R	T	110	110	185	120	75
315 x 160	R	T	128	128	180	120	85
315 x 200	R	T	150	150	185	120	100
315 x 250	R	T	183	183	190	120	110
315 x 315	R	T	213	213	195	120	120
400 x 110	R	T	148	148	220	145	70
400 x 125	R	T	148	148	220	145	75
400 x 160	R	T	148	148	220	145	85
400 x 200	R	T	180	180	225	145	100
400 x 250	R	T	180	180	225	145	110
400 x 315	R	T	275	275	240	165	120
400 x 400	R	T	275	275	240	165	145
500 x 110	R	T	160	160	310	200	70
500 x 125	R	T	160	160	310	200	75
500 x 160	R	T	160	160	310	200	85
500 x 200	R	T	220	220	315	200	100
500 x 250	R	T	220	220	315	200	110
500 x 315	R	T	300	300	320	200	120
500 x 400	R	T	300	300	325	200	145
500 x 500	R	T	350	350	400	200	200
630 x 630	R	T	470	470	415	225	225

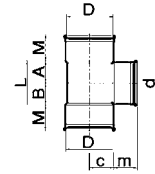

### Legend.

- F** = Fixed rubber ring
- R** = Removable rubber ring
- I** = Injection moulded
- T** = Thermo formed

## T-piece 45° - 3 x RS



Ø / D x d			A	B	c	M	m
110 x 110	F	I	133	28	138	64	64
125 x 110	F	I	146	26	149	64	61
125 x 125	F	I	153	35	156	62	62
160 x 110	F	I	156	6	167	69	60
160 x 125	F	I	174	18	179	88	72
160 x 160	F	I	196	42	196	69	69
200 x 110	R	T	250	40	235	100	70
200 x 125	F	I	196	-3	203	92	73
200 x 160	F	I	224	14	222	92	89
200 x 200	F	I	244	47	244	92	92
250 x 110	R	T	280	10	270	110	70
250 x 125	R	T	280	10	280	110	75
250 x 160	R	T	310	40	295	110	85
250 x 200	R	T	330	70	325	110	100
250 x 250	R	T	380	100	350	110	110
315 x 110	R	T	315	-15	320	120	70
315 x 125	R	T	315	-15	325	120	75
315 x 160	R	T	340	10	340	120	85
315 x 200	R	T	375	40	370	120	100
315 x 250	R	T	415	75	400	120	110
315 x 315	R	T	465	125	430	120	120
400 x 110	R	T	395	-25	380	145	70
400 x 125	R	T	395	-25	385	145	75
400 x 160	R	T	395	-25	400	145	85
400 x 200	R	T	445	30	430	145	100
400 x 250	R	T	445	30	450	145	110
400 x 315	R	T	520	190	460	145	120
400 x 400	R	T	580	230	640	145	145
500 x 110	R	T	415	-95	500	200	70
500 x 125	R	T	475	-35	500	200	75
500 x 160	R	T	475	-35	500	200	85
500 x 200	R	T	550	50	565	200	100
500 x 250	R	T	550	50	600	200	110
500 x 315	R	T	600	100	635	200	120
500 x 400	R	T	650	150	700	200	145
500 x 500	R	T	750	250	735	200	200

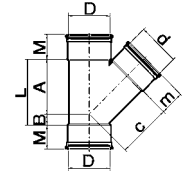

## Double T-piece 90° - 3 x RS



Ø / D x d				L	A	a	Z
160 x 110	R	T		400	85	70	100
160 x 160	R	T		400	85	85	100
200 x 110	R	T		400	100	70	120
200 x 200	R	T		480	100	100	125
250 x 110	R	T		425	110	70	145
250 x 160	R	T		465	110	85	150
250 x 200	R	T		510	110	100	150
250 x 250	R	T		565	110	110	155
315 x 315	R	T		660	120	120	195
400 x 200	R	T		630	145	100	225
500 x 200	R	T		800	200	100	315
500 x 500	R	T		1000	200	200	400

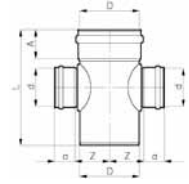

## Double T-piece 45° - 3 x RS



Ø / D x d				L	A	a	Z1	Z2
160 x 110	R	T		425	85	70	220	210
160 x 160	R	T		490	85	85	250	230
200 x 110	R	T		490	100	70	250	235
200 x 160	R	T		515	100	85	265	260
200 x 200	R	T		590	100	100	300	285
250 x 110	R	T		510	110	70	280	270
250 x 160	R	T		570	110	85	310	295
250 x 200	R	T		620	110	100	330	325
250 x 250	R	T		700	110	110	380	350
315 x 250	R	T		725	120	110	415	400
315 x 315	R	T		825	120	120	465	430

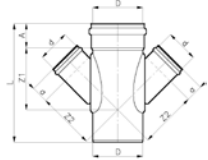

## Double T-piece 90° - 4 x RS



Ø / D x d				L	A	a	Z
200 x 200	R	T		480	100	100	125
315 x 200	R	T		540	120	100	185
500 x 500	R	T		1100	200	200	400

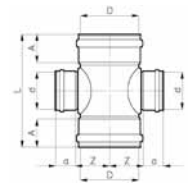

## Double T-piece 45° - 4 x RS



Ø / D x d				L	A	a	Z1	Z2
200 x 200	R	T		590	100	100	300	330
250 x 200	R	T		620	110	100	330	325
315 x 200	R	T		655	120	100	375	370

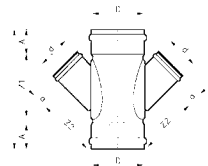

## Rodding piece - 2 x RS



Ø / D			A	L	C	M	x
110 mm	F	I	63	126	85	64	125
125 mm	F	I	80	160	102	72	160
160 mm	F	I	77	154	120	89	160

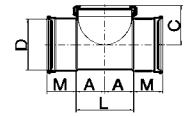

## Rodding piece - 2 x RS



Ø / D			L	C	M	A x B
125 mm	F	I	258	90	72	250 x 125
160 mm	F	I	286	120	86	255 x 152

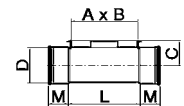

## Reducer - 1 x RS



Ø / D x d			A	B	L	E	M
125 x 110	F	I	14	69	83	7	64
160 x 110	F	I	33	85	118	25	64
160 x 125	F	I	25	86	111	17	72
200 x 125	F	I	50	90	140	38	72
200 x 160	F	I	28	91	119	19	89
250 x 160	R	T	105	140	245		85
250 x 200	R	T	70	145	215		100
315 x 200	R	T	135	155	290		100
315 x 250	R	T	85	150	235		120
400 x 315	R	T	110	180	290		120
500 x 400	R	T	142	188	330		165

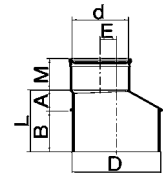

## Semi ecc. reducer - 1 x RS



Ø / D x d			L	A	B	Z
315 x 110	R	T	300	70	145	85
315 x 160	R	T	315	85	145	85
400 x 200	R	T	370	100	165	105
400 x 250	R	T	380	110	165	105

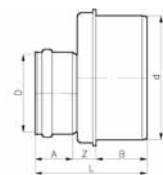

## Centric reducer - 1 x RS



Ø / D x d			L	A	B	Z
400 x 200	R	T	370	100	165	105
400 x 315	R	T	395	120	165	110
500 x 315	R	T	280	120	180	-20

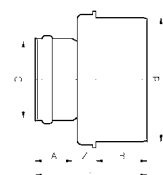

## End cap



Ø / D		L
110 mm	I	36
125 mm	I	37
160 mm	I	37
200 mm	I	46
250 mm	T	37
315 mm	T	47
400 mm	T	80
500 mm	T	55
630 mm	T	95

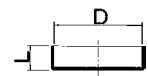

## End piece with screw cover



Ø / D		A	B	L	D1
110 mm	I	21	65	86	124
125 mm	I	23	71	94	141
160 mm	I	28	96	124	177

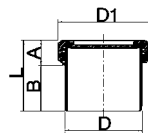

## End cap in socket



Ø / D	
110 mm	I
125 mm	I
160 mm	I
200 mm	I
250 mm	T
315 mm	T
400 mm	T

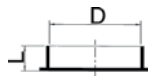

## Rest bend - 1 x RS



Ø / D		F	I	M	A	B
110 mm		F	I	60	160	220

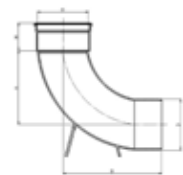

## Rest bend - 2 x RS



Ø / D		F	I	M	A
110 mm		F	I	60	160

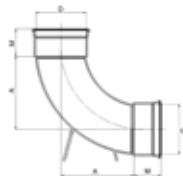

### Legend.

- F** = Fixed rubber ring
- R** = Removable rubber ring
- I** = Injection moulded
- T** = Thermo formed





Certificate



**kiwa**  
Partner for progress

**KOMO®**  
Product certificate

Number: 0001/04/01	Revision: 1
Issue date: 08/04/01	Valid until: 08/04/07
Issue by: kiwa/01	Page: 1 of 4

**Fittings of PVC for outside buildings non-pressure**

**Dyka B.V.**

Continued on other pages  
This product certificate is issued on the basis of EN 12201 'Plastic piping systems for non-pressure underground drainage and sewerage' A.B. 2004/1 in accordance with the Kiwa registration procedure 'Product certificate'.  
Kiwa declares that inspection certificates issued for this fit the production manufacturer products comply with the technical specifications as set out in this product certificate provided that the manufacturer complies with the ISO 9001 standard for the production of products in the product certificate.

*[Signature]*  
Boudier-Moekens  
Director Kiwa, NV

Address: 00001/01 [www.kiwa.nl](http://www.kiwa.nl) or write to kiwa@kiwa.nl or kiwa@kiwa.com



Registered  
Manufacturing  
Product  
Certificate

Certificate



**kiwa**  
Partner for progress

Number: K22142/01	Revision: K22142/01
Issue date: 2001-12-01	First issue: 2002-07-01
Valid until: 2004-12-01	Issue: 14

**Certificate**  
**ISO 9001**

Kiwa has determined that the quality management system employed by **DYKA B.V.** and its implementation comply with ISO 9001:2000 for the scope:  
The design, production and sales of plastic pipes.

*[Signature]*  
Boudier-Moekens  
Kiwa

Please contact the certified company for more information about the scope of this certificate in relation to the ISO 9001:2000 standard.

This certificate consists of 1 page.  
Publication of the certificate is allowed.

Kiwa Nederland B.V.  
De Waarder (Stationsplein) 210  
Postbus 10  
3200 AA Alphen aan de Rijn  
The Netherlands

Tel. +31 78 414 40 00  
Fax +31 78 414 40 00  
[info@kiwa.nl](mailto:info@kiwa.nl)  
[www.kiwa.nl](http://www.kiwa.nl)

**Company**  
DYKA B.V.  
Productieweg 7  
8331 LJ Steenwijk  
The Netherlands  
AAN A.A. 8333ANWIK  
Tel. 0522-249911  
Fax 0522-249975  
E-mail: [info@dyka.nl](mailto:info@dyka.nl)  
Internet: [www.dyka.nl](http://www.dyka.nl)

**Sales points**

Almere	Caen
Assen	Carignan
Breda	Genève (CH)
Den Bosch	Louvain-la-Neuve
Die Feijeg	Rotterdam
Dronen	Stavelot
Druckem	Tal
Druckem	Utrecht
Enschede	Wint



**BELGIAN CONSTRUCTION CERTIFICATION ASSOCIATION npo**

Founded by: BBN and SECO

Nr: 430004

K: 800  
E: 601  
C: 201  
C: 13001  
E: 201

Valid from: 01/03/2014 to: 08/03/2017

Site of Action 05, B - 1340 BRUXELLES  
Tel. : +32 2 238 24 11  
Fax. : +32 2 238 24 01

[www.bcca.be](http://www.bcca.be)

**BENOR**

**PRODUCT CERTIFICATE**

BCCA declares that has been established that the applicant **DYKA B.V., Productieweg, 7, NL - 8331 LJ Steenwijk** takes the necessary measures in order to ascertain that the products: **Components of unplasticized poly vinyl chloride (PVC-U) for the component group C1: bends for the diameter group D1** manufactured in the factory located at **DYKA B.V., Productieweg, 7, NL - 8331 LJ Steenwijk** may correspond with the performances described in the standard **EN 12201-1** **Plastics piping systems for non-pressure underground drainage and sewerage - Unplasticized poly(vinyl chloride) (PVC-U) and the PTV 1005**

The certificate is delivered based on a study and an acceptance of the relevant **initial type tests (ITT)**, executed on relevant samples taken from the production unit and on basis of an initial inspection of the production and the **factory production control system (FPC)**.

BCCA confirms that the manufacturer applies a valid production control system and executes regular testing on samples taken from the production according to a fixed testing program. BCCA supervises the production and the production control system during the yearly audit of the FPC, periodical control of the internal control results and witness-testing.

On basis of the delivery and the maintenance of this certificate, the manufacturer is authorized to use the BENOR-sign as a means to attest the conformity of his products.

This certificate is valid during the period mentioned left side of this document, provided that the specification of the standard and the regulatory conditions are not modified.

Brussels, 08 March 2014

*[Signature]*  
r. Benny De Blaere  
General Manager





**BELGIAN CONSTRUCTION CERTIFICATION ASSOCIATION npo**

Founded by: BBN and SECO

Nr: 430004

K: 800  
E: 601  
C: 13001 + FPC  
C: NL-STE

Valid from: 01/03/2014 to: 08/03/2017

Site of Action 05, B - 1340 BRUXELLES  
Tel. : +32 2 238 24 11  
Fax. : +32 2 238 24 01

[www.bcca.be](http://www.bcca.be)

**BENOR**

**PRODUCT CERTIFICATE**

BCCA declares that has been established that the applicant **Dyka bv, Productieweg 7, NL - 8331 LJ Steenwijk** takes the necessary measures in order to ascertain that the products: **PP inspection chambers with internal diameter from: DN 200 to DN 400 with maximum buried depth of 2 m, measured from the bottom** manufactured in the factory located at **Dyka bv, Productieweg 7, NL - 8331 LJ Steenwijk** can be in conformity with the performances described in **EN 12206-1** **Plastics piping systems for non-pressure underground drainage and sewerage - Unplasticized poly(vinyl chloride) (PVC-U), polypropylene (PP) and polyethylene (PE) Specifications for ancillary fittings including of active inspection chambers.**

The certificate is delivered based on a study and an acceptance of the relevant **initial type tests (ITT)**, executed on relevant samples taken from the production unit and on basis of an initial inspection of the production and the **factory production control system (FPC)**.

BCCA confirms that the manufacturer applies a valid production control system and executes regular testing on samples taken from the production according to a fixed testing program. BCCA supervises the production and the production control system during the yearly audit of the FPC, periodical control of the internal control results and witness-testing.

On basis of the delivery and the maintenance of this certificate, the manufacturer is authorized to use the BENOR-sign as a means to attest the conformity of his products.

This certificate is valid during the period mentioned left side of this document, provided that the specification of the standard and the regulatory conditions are not modified.

Brussels, 20 August 2013.

*[Signature]*  
r. Benny De Blaere  
General Manager



**Kitemark® Licence**



No. KM 59600

BSI hereby grants to:  
**Dyka Steenwijk BV**  
 Produktieweg 7  
 8330 AA  
 Steenwijk  
 Netherlands

In respect of  
**Plastics piping systems for non-pressure underground drainage and sewerage**  
 - Unplasticized poly(vinyl chloride)(PVC-U)

The right and Licence to use the Kitemark in accordance with the Kitemark Licence Conditions of Contract governing the use of the Kitemark, as may be updated from time to time by BSI, and as approved by the Registrar under the Trade Marks Act 1994 (the "Conditions"). All related terms in this Licence shall have the same meaning as in the Conditions.

The use of the Kitemark is authorized in respect of the Product(s) detailed on this Licence provided at or from the above address.

For and on behalf of BSI:



Alison Truitt, Managing Director, BSI Product Services - Global

Test granted: 21 Nov 2003      Date: 10 Jul 2007      Page: 1 of 2



BSI Product Services  
 389 Chiswick Avenue, Uxbridge, Middlesex, UK UB8 3PH  
 Tel: +44 (0)1875 333300    Email: bsi@bsi.com

**SWEDCERT**  **kiwa**  
 Företag för program

**TYPGODKÄNNANDE I168**  
 MED BESLUT OM TILLVERKNINGSKONTROLL

SAKORD: Installationer för avloppsvatten      BBR 6-04  
 Formstycken

**Innehavare**  
 Dyka B.V. Produktieweg 7, P.O. Box 33, 8330 AA Steenwijk  
 Tel: +31 (0)521 344011, Fax: +31 (0)521 234071  
 E-post: info@dyka.nl, hemsida: www.dyka.nl

**Produktnamn: Dyka formstycken av PVC**  
 Formstycken (Njlar, knäpluggar och T-stycken) av PVC utvalda enligt standard SS-EN 1401-1

**Är avsedd användning**  
 Avsedd användning är avsedda till anslutning av avloppsvatten i mark. System avsedda för maskinfästning (klassas enligt standarden SS-EN 1401-1) i skåpkan till och i klasserna SN 4 och SN 8.

**Guldsmeder**  
 Produktion utförd och kontrollert enligt tillämpliga handlingar påskrivna nedan avseende på följande aspekter i Boverkets byggregler (BRG):  
 Byggregulator med bespärade rögnippor      1.4  
 Innehållsvärde för spillvatten      6.441  
 Innehållsvärde för dagvatten      6.442  
 Utformning      6.444

For avsedd användning applicer för produktens följande klass i PBL - Plan- och bygglagen 1 kap 4 § Byggregulatorer tekniska egenskaper  
 1. Beständighet  
 2. Skydd mot läckage till byggnad, läsa och miljö

Bilaga 1: Tillämpliga handlingar      2013-12-19  
 Bilaga 2: Produktkontroll      2013-12-19  
 Bilaga 3: Kontrollplan-integet      2013-12-19  
 Bilaga 4: Produktionskontroll      2013-12-19

**Kina Sverige AB**  
 Campus Gråvik 1  
 271 75 Kullerås  
 Sweden  
 Tel: 0873 46 36 86  
 Fax: 0873 236 76  
 info@kina.se  
 www.kina.se

Utfärdat: 2013-12-20      Datum: 2013-12-19  
 Giltigt till: 2018-12-19

**Kina Sverige AB**  
 Henrik Wulger  
 Niklas Johansson  
 Teknisk Samordningsansvarig      Teknisk ansvarig

**BCCA**

**BELGIAN CONSTRUCTION CERTIFICATION ASSOCIATION npo**

Founded by BBR and SICO

**BENOR**

**PRODUCT CERTIFICATE**

BCCA declares that has been established that the applicant  
**Dyka bv**  
 Produktieweg 7  
 NL - 8331 LJ STEENWIJK

takes the necessary measures in order to ascertain that the products

PP, injection molding, inspection chambers with internal diameter DN 600 (class 2) with maximum buried depth of 6 m, measured from the bottom and with the maximum level of underground water of 6 m

manufactured in the factory located at  
**Dyka bv**  
 Produktieweg 7  
 NL - 8331 LJ STEENWIJK

can be in conformity with the performance described in **ENR EN 12050-2**  
 Plastic piping system for non-pressure underground drainage and sewerage - Engineered poly(vinyl chloride) PVC (PVC-U) sub-systems (PP) and polyethylene (PE) - Applications for modules and inspection chambers in traffic areas and deep underground installations.

The certificate is delivered based on a study and an acceptance of the relevant initial type tests (ITT), executed on relevant samples taken from the production unit and on basis of an initial inspection of the production and the factory production control system (FPC).

BCCA confirms that the manufacturer applies a valid production control system and executes regular testing on samples taken from the production according to a fixed testing program. BCCA supervises the production and the production control system during the yearly audit of the FPC, periodical control of the internal control results and witness testing.

On basis of the delivery and the maintenance of this certificate, the manufacturer is authorized to use the BENOR logo as a means to attest the conformity of his products.

This certificate is valid during the period mentioned left side of this document, provided that the specification of the standard and the regulatory conditions are not modified.

Statenik, 20 August 2012



A. Storme De Beert  
 General Manager

Nr: 48-0-0  
 A: 005  
 K: 001  
 U: 201  
 C: 12050-2 PP  
 E: 001

Vat: 01102012  
 In: 01102018

Ref of Act of 03.08.1986 BRUSSELS  
 Tel: +32 2 238 34 11  
 Fax: +32 2 238 34 01  
 www.bcca.be

**BCCA**

**BELGIAN CONSTRUCTION CERTIFICATION ASSOCIATION npo**

Founded by BBR and SICO

**BENOR**

**PRODUCT CERTIFICATE**

BCCA declares that has been established that the applicant  
**Dyka bv**  
 Produktieweg 7  
 NL - 8331 LJ Steenwijk

takes the necessary measures in order to ascertain that the products

PVC connection pieces, with nominal external diameter DN 120 and DN 160, for connection to non-pressure PVC-U drainage and sewerage pipes

manufactured in the factory located at  
**Dyka bv**  
 Produktieweg 7  
 NL - 8331 LJ Steenwijk

can be in conformity with the performance described in **ENR EN 12050-2**  
 Plastic piping systems - Factory-made connection pieces of unplasticized poly(vinyl chloride) (PVC-U) for connection to non-pressure PVC-U drainage and sewerage pipes.

The certificate is delivered based on a study and an acceptance of the relevant initial type tests (ITT), executed on relevant samples taken from the production unit and on basis of an initial inspection of the production and the factory production control system (FPC).

BCCA confirms that the manufacturer applies a valid production control system and executes regular testing on samples taken from the production according to a fixed testing program. BCCA supervises the production and the production control system during the yearly audit of the FPC, periodical control of the internal control results and witness testing.

On basis of the delivery and the maintenance of this certificate, the manufacturer is authorized to use the BENOR logo as a means to attest the conformity of his products.

This certificate is valid during the period mentioned left side of this document, provided that the specification of the standard and the regulatory conditions are not modified.

Statenik, 20 August 2012



A. Storme De Beert  
 General Manager

Nr: 48-0-0  
 A: 005  
 K: 001  
 U: 201  
 C: 12050-2  
 E: 001

Vat: 01102012  
 In: 01102018

Ref of Act of 03.08.1986 BRUSSELS  
 Tel: +32 2 238 34 11  
 Fax: +32 2 238 34 01  
 www.bcca.be

