

PP Soil & Waste

S20



DYKA



Injection moulding department



DYKA plant

At DYKA

We proudly state that we can provide you “just-in-time” with all possible solutions for your specific requirements related to plastic pipe systems. Our “no-nonsense” statement is based on the following impressive figures and facts: The DYKA premises near the town of Steenwijk in the Netherlands, solely occupies some 180.000 m². A full-service plant with automated production lines, special engineering department, quality control, research & development, storage and logistics.

Injection moulding

Our large number of special moulding machines do produce more than 44 million items per year, in any size and shape.

Thermo forming

Flexibility and enormous innovative capacity offered by thermo forming have resulted in our company’s impressive range of plastic fittings. A product range that still offers ample potential for expansion, new applications are continually being discovered, and other plastics are being tested for their suitability for this renowned manufacturing technology.

Extrusion

Excellent tuned extrusion lines do assure the non-stop production of pipes and conduits in every possible colour, diameter and specific technical specifications. Total output: more than 55.000 kilometres of plastic pipes per year!

Storage & Logistics

Every day, full truck-loads and containers are shipped from our production plants in Europe, by road, air, train and waterway to satisfy the needs of our customers all over the world.

Export Sales

Our eager export staff is only too willing to serve and assist you with technical advice, customs documents and after-sales service.

Whatever you might need AT DYKA, we can do it for you!

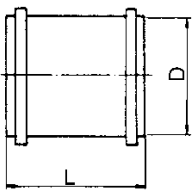

Slip Coupling

	Ø / D	Qty/ Box	L	
	32		98	
	40	350	102	
	50	275*	104	
	75	120	115	
	90	65*	114	
	110	40	128	

Coupling

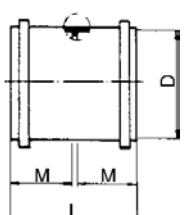
	Ø / D	Qty/ Box	M	L	
	32	600	48	98	
	40	350*	49	102	
	50	275*	51	104	
	75	120	56	115	
	90	65*	56	114	
	110	40	63	128	

Bend 45° socket x socket

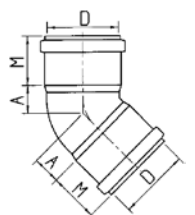
	Ø / D	Qty/ Box	M	A	
	32	500	41	14	
	40	300	43	16	
	50	200	44	18	
	75	100	47	24	
	90	60*	49	28	
	110	35	58	34	

Bend 90° socket x socket

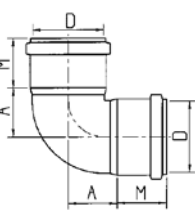
	Ø / D	Qty/ Box	M	A	
	32	500	41	22	
	40	300	43	27	
	50	170	44	32	
	75	80	47	45	
	90	50	49	53	
	110	30	58	65	

Bend 15° socket x spigot



Ø / D	Qty/ Box	M	A	B
40	300*	44	9	50
50	200	44	12	52
75	100	51	11	59
110	35	62	13	68

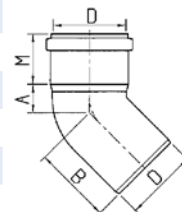

Bend 30° socket x spigot



Ø / D	Qty/ Box	M	A	B
32	600*	42	10	48
40	300*	44	11	52
50	200	44	15	56
75	100	51	16	64
110	35	62	21	76

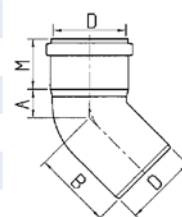

Bend 45° socket x spigot



Ø / D	Qty/ Box	M	A	B
32	600	41	14	53
40	300	43	16	57
50	200	44	18	60
75	100	47	24	71
90	60*	49	28	74
110	35	58	34	90

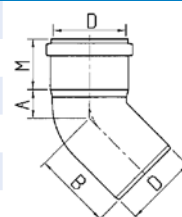

Bend 90° socket x spigot



Ø / D	Qty/ Box	M	A	B
32	500	41	23	64
40	300	43	27	70
50	170	44	32	76
75	80	47	45	94
90	50	49	53	101
110	30	58	65	123

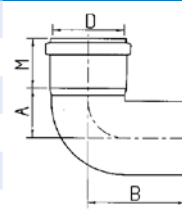

Tee 45° socket x socket x socket



Ø / D	Qty/ Box	d	M	m	A	B	C	L
32	250	32	43	43	45	13	45	58
40	175*	40	47	47	53	19	53	72
50	100	50	49	49	66	20	66	86
50x40	100	40	49	47	66	20	63	86
75	40	75	47	47	95	24	95	119
75x40	40	40	51	47	75	10	79	85
75x50	40	50	47	44	78	6	82	84
90	25*	90	54	54	116	33	116	149
110	15	110	53	53	134	29	134	163
110x40	25	40	57	47	92	-12	105	80
110x50	25	50	57	49	96	-2	109	94
110x75	25	75	57	51	114	9	122	123

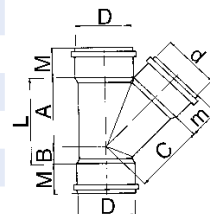

Tee 90° socket x socket x socket



Ø / D	Qty/ Box	d	M	m	A	B	C	L
32	250	32	43	43	45	25	25	50
40	175	40	43	43	27	27	27	53
50	100	50	44	44	32	32	32	64
50x40	100	40	49	47	17	43	46	60
75	40	75	51	51	49	64	64	113
75x40	40	40	51	47	19	45	57	64
75x50	40	50	51	49	21	55	65	76
90	25*	90	56	54	61	61	58	123
110	15	110	57	57	62	120	62	182
110x40	15	40	57	47	35	53	78	88
110x50	15	50	57	49	38	52	78	90
110x75	15	75	57	51	47	69	79	116

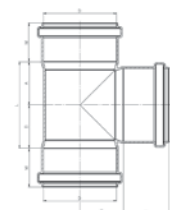

Tee 45° socket x socket x spigot



Ø / D	Qty/ Box	d	M	m	A	B	C	L
32	250	32	43	43	45	13	45	58
40	175*	40	47	47	53	64	53	117
50	100	50	49	49	66	68	66	134
50x40	100	40	49	47	66	20	63	86
75	40	75	47	47	96	75	96	171
75x40	40	40	51	49	75	60	79	135
75x50	40	50	47	44	78	51	82	129
90	25*	90	54	54	116	33	116	149
110	15	110	57	57	134	88	134	222
110x40	25	40	57	47	92	-12	105	80
110x50	25	50	57	49	95	69	95	164
110x75	25	75	57	51	114	62	122	176

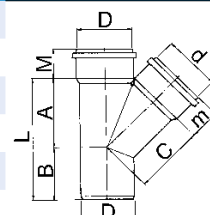

Tee 90° socket x socket x spigot



Ø / D	Qty/ Box	d	M	m	A	B	C	L
32	250	32	43	43	45	25	25	50
40	175	40	43	43	27	69	27	96
50	100	50	44	44	32	75	32	107
50x40	100	40	49	47	17	43	46	60
75	40	75	51	51	49	106	64	155
75x40	40	40	51	47	19	45	57	64
75x50	40	50	51	49	21	100	65	121
90	25*	90	56	54	61	61	58	123
110	15	110	57	57	62	120	62	182
110x40	15	40	57	47	35	99	78	134
110x50	15	50	57	49	38	103	78	141
110x75	15	75	57	51	47	118	79	165

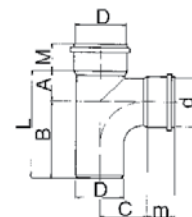

Reducer short EXC spigot x socket



Ø / D	Qty/ Box	d	M	A	L
40x32	350*	32	42	0	51
50x32	275*	32	42	0	51
50x40	275*	40	46	0	52
75x40	240	40	47	8	54
75x50	240	50	50	5	56
90x75	130*	75	52	0	60
110x40	100	40	47	25	64
110x50	100	50	49	20	64
110x75	100	75	51	8	64
110x90	100	90	52	2	64

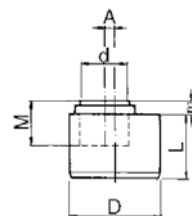

End cap socket



Ø / D	Qty/ Box	H
40		66
50		
75		
110		

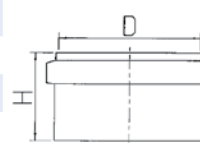

End piece with screw cover



Ø	Qty/ Box
75	
110	

Rodding piece socket x socket



Ø / D	Qty/ Box	M	A	B	C	L
110	15	57	43	140	125	183

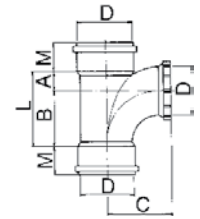

Rodding piece socket x spigot



Ø / D	Qty/ Box	A	B	C	L	L
110	15	43	192	125	235	183

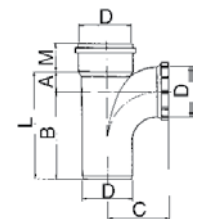

End cap spigot



Ø / D	Qty/ Box	H
32		35
40		35
50		35
75		34,5
110		40

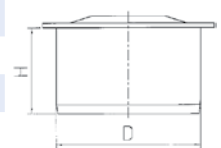

Fixation bracket for end cap spigot



Ø
50
75
110



Certificate
KSC-K22342/09

Issued	2019-06-15	Registers	KSC-K22342/09
Valid until	2022-06-15	First issued	2002-07-01



CERTIFICATE

ISO 9001

Kiwa has determined that the quality management system applied by **Dyka B.V.** and its implementation comply with NEN-EN-ISO 9001:2015 for the scope:

The development, production and supply of plastic piping systems. Providing related (trade) items, tailor-made solutions, technical advice and logistic service.



Ronald Karel
Kiwa

Please contact the certified company for more information about the scope of this certificate in relation to the ISO 9001:2015 standard.

The certificate consists of 1 page
Publication of this certificate is allowed.

Kiwa Nederland B.V.
St. Wastel Churchplein 273
Postbus 70
NL-2280 AB Rijswijk
Tel: +31 (0) 9004 00
Fax: +31 (0) 9004 30
info@kiwa.nl
www.kiwa.nl

Company
Dyka B.V.
Populiersweg 7
NL-8331 LJ STEDEWALDE
Postbus 30
NL-8330 AA STEDEWALDE
Tel: +31 (0) 43400
info@dyka.nl
www.dyka.nl
tva: 0021200



Certificate
MSC-K56663/05

Issued	2019-06-15	Registers	MSC-K56663/04
Valid until	2022-06-15	First issued	2010-06-15



CERTIFICATE

ISO 14001

Kiwa has determined that **Dyka B.V.** the environmental management system and its implementation comply with NEN-EN-ISO 14001:2015 for the scope:

The development, production and supply of plastic piping systems. Providing related (trade) items, tailor-made solutions, technical advice and logistic service.



Ronald Karel
Kiwa

The certificate consists of 1 page
Publication of this certificate is allowed.

Kiwa Nederland B.V.
St. Wastel Churchplein 273
Postbus 70
NL-2280 AB Rijswijk
Tel: +31 (0) 9004 00
Fax: +31 (0) 9004 30
info@kiwa.nl
www.kiwa.nl

Company
Dyka B.V.
Populiersweg 7
NL-8331 LJ STEDEWALDE
Postbus 30
NL-8330 AA STEDEWALDE
Tel: +31 (0) 43400
info@dyka.nl
www.dyka.nl
tva: 0021200





KOMO®
Product certificate
K26141/06



Issued	2018-01-01	Replaces	K26141/05
Valid until	Indefinite	Dated	2017-02-15
Page	1 of 4		

CERTIFICATE

Fittings of polypropylene for sewerage inside buildings

Dyka B.V.

STATEMENT BY KIWA

This product certificate is issued on the basis of BRL 2042 "Plastic piping systems for soil and waste discharge - polypropylene (PP)" dated 1 September 2017, conform the Kiwa-Regulations for Certification.

The quality system and product characteristics in association with the fittings of polypropylene for sewerage inside buildings are assessed periodically.

On this basis Kiwa declares that a justified confidence exists, that the fittings of polypropylene for sewerage inside buildings delivered by the certificate holder at delivery fulfill:

- the technical specification laid down in this product certificate,
- the product requirements as laid in the BRL.

provided that the fittings of polypropylene for sewerage inside buildings have been marked with the KOMO®-mark in a manner as indicated in this product certificate;

Luc Leroy
Kiwa

*The certificate is listed in the overview on the website of Stichting KOMO: www.komo.nl.
Advice: consult www.kiwa.nl in order to ensure that this certificate is still valid.*

Kiwa Nederland B.V.
Sir Winston Churchilllaan 273
Postbus 70
2200 AD RUISWIJK
The Netherlands
Tel. +31 88 398 44 00
Fax +31 88 996 44 20
info@kiwa.nl
www.kiwa.nl

Holder of Certificate
Dyka B.V.
Produkieweg 7
8331 LJ STEENWIJK
Postbus 33
8330 AA STEENWIJK
The Netherlands
Tel. +31 (0)521-634911
Fax +31 (0)521-634371
info@dyka.nl
www.dyka.nl

Production location
Dyka B.V.
Produkieweg 7
8331 LJ STEENWIJK
Postbus 33
8330 AA STEENWIJK
The Netherlands
Tel. +31 (0)521-634911
Fax +31 (0)521-634371
info@dyka.nl
www.dyka.nl

Production location
DTH Fitting Kft.
Földes út 36-37
3636 VADNA
Hungary
Tel. +36 48 505 042
Fax +36 48 345 500
fitting@nth.eu
www.dth.eu



Evaluated is:
quality system
product
Periodic inspection

